

OIL COOLER SYSTEM FOR SOLVENT RECYCLERS

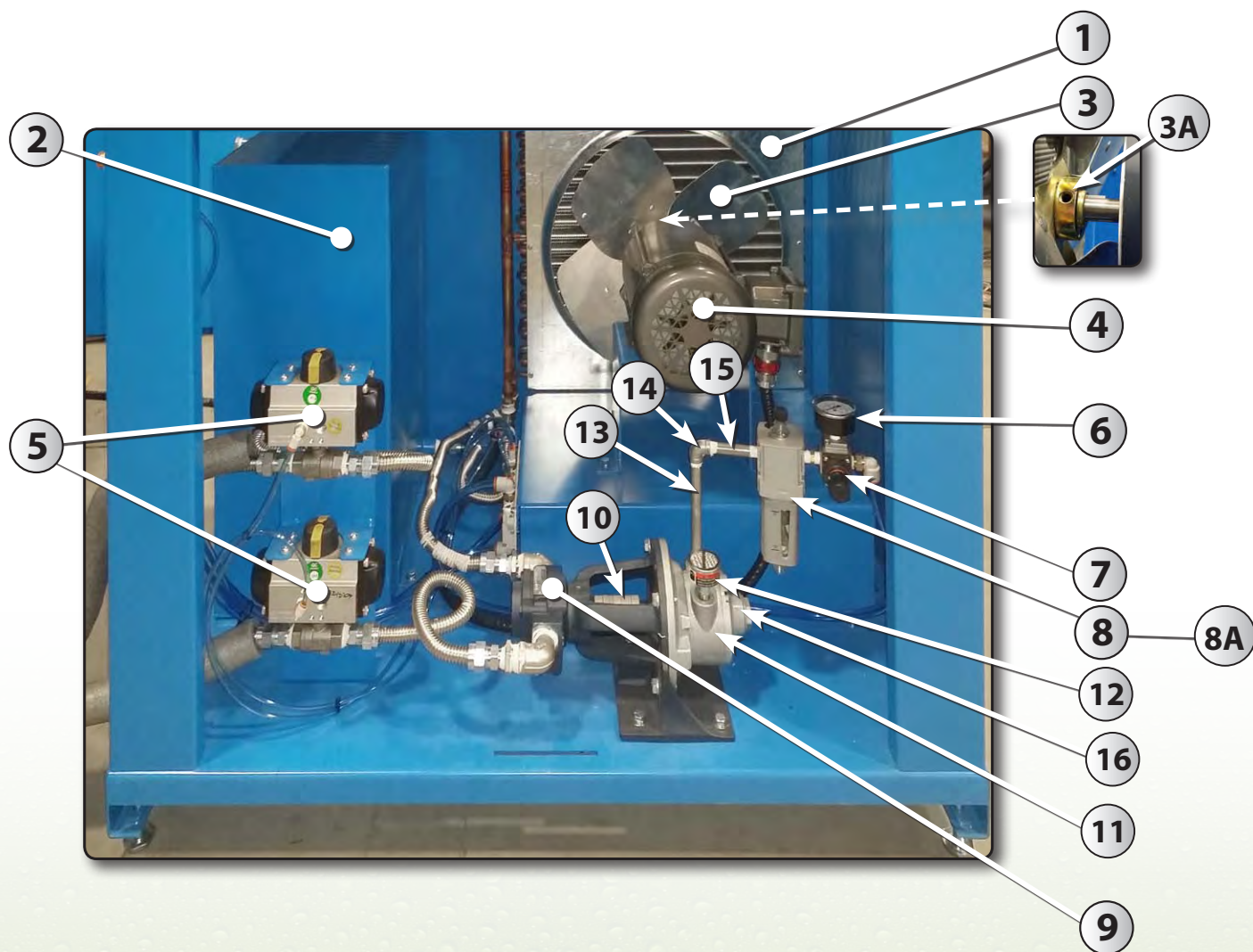

INSIDE VIEW - MAIN PARTS



ID	Part #	Description
1	305005	RADIATOR
2	NPN	OIL TANK
3	303012	MOTOR FAN
3A	303011	HUB 5/8"
4	303021	1 HP / 460 V MOTOR
	303015	1 HP / 600 V MOTOR
5	324509	1/2" ROTEX VALVE
6	311002	AIRL PRESSURE INDICATOR
7	608015	1/4" AIR PRESSURE REGULATOR

ID	Part #	Description
8	934029	OILER
8A	934030	OIL
9	324539	HIGH TEMP. SEALS PUMP
10	324528	SHAFT COUPLING
11	324527	PUMP MOTOR
12	324529	MOTOR MUFFLER
13	324507	1/4" X 6" NIPPLE
14	323555	1/4" 90° ELBOW
15	323508	NIPPLE 1/4" X 3" LG .
16	324518	PUMP BRACKET

INSIDE VIEW - DETAIL PARTS

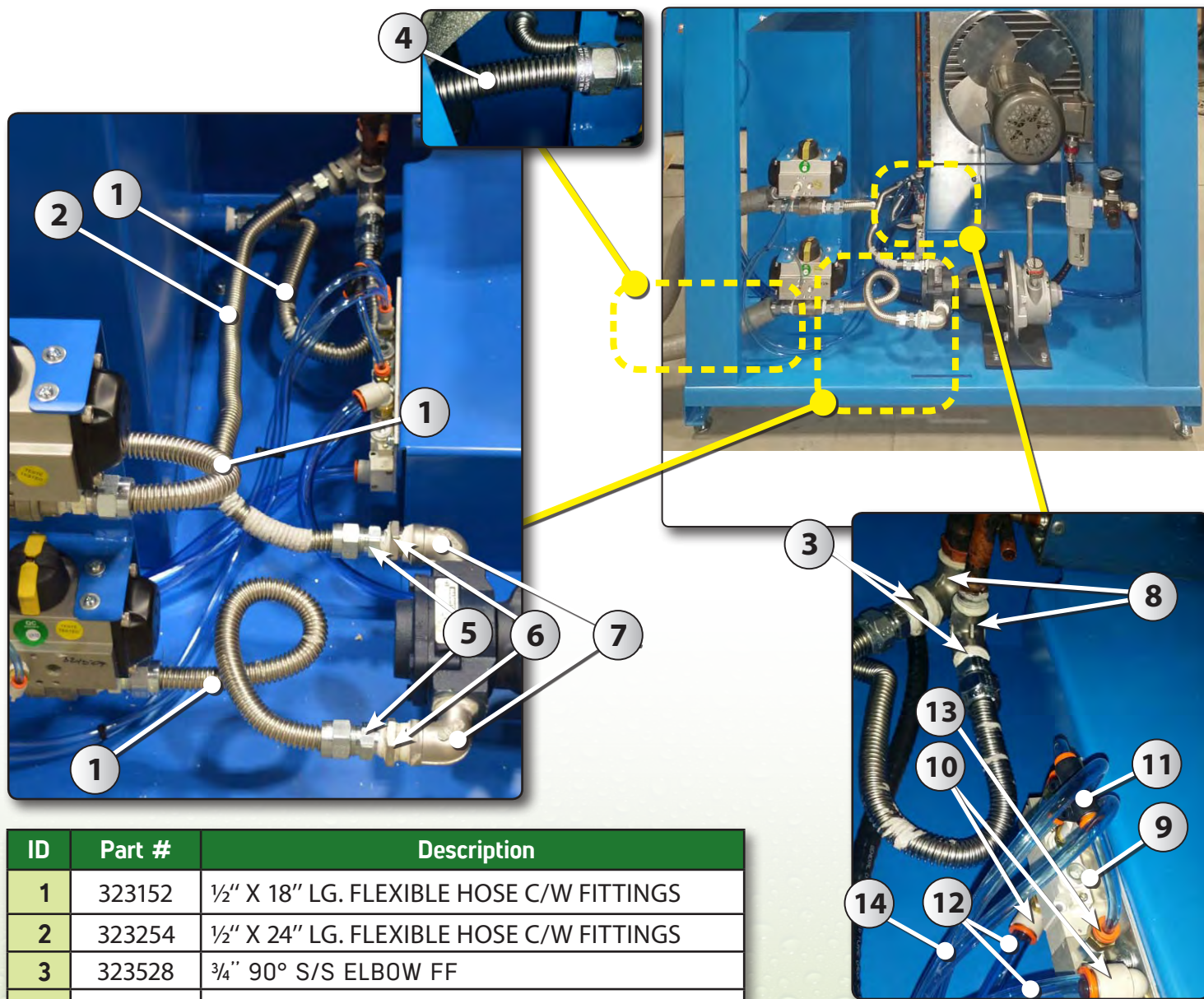

ID	Part #	Description
1	323152	1/2" X 18" LG. FLEXIBLE HOSE C/W FITTINGS
2	323254	1/2" X 24" LG. FLEXIBLE HOSE C/W FITTINGS
3	323528	3/4" 90° S/S ELBOW FF
4	323246	1/2" " X 60" LG. FLEXIBLE HOSE C/W FITTINGS
5	323149	FITTING ONLY
6	323535	REDUCER 3/4" TO 1/2"
7	332192	3/4" 90° S/S ELBOW MF
8	323533	1/2" 90° ELBOW FF
9	608534	PILOT VALVE
10	314058	PUSH-IN 90° 1/4" NPT X 1/2" TUBE
11	324584	PUSH-IN TEE 1/4" TUBE
12	314025	POLYURETHANE HOSE 1/2"
13	324570	PUSH-IN 1/8" NPT - 1/4" TUBE
14	324571	POLYURETHANE HOSE 1/4"

INSIDE VIEW - DETAIL PARTS - CONT'D

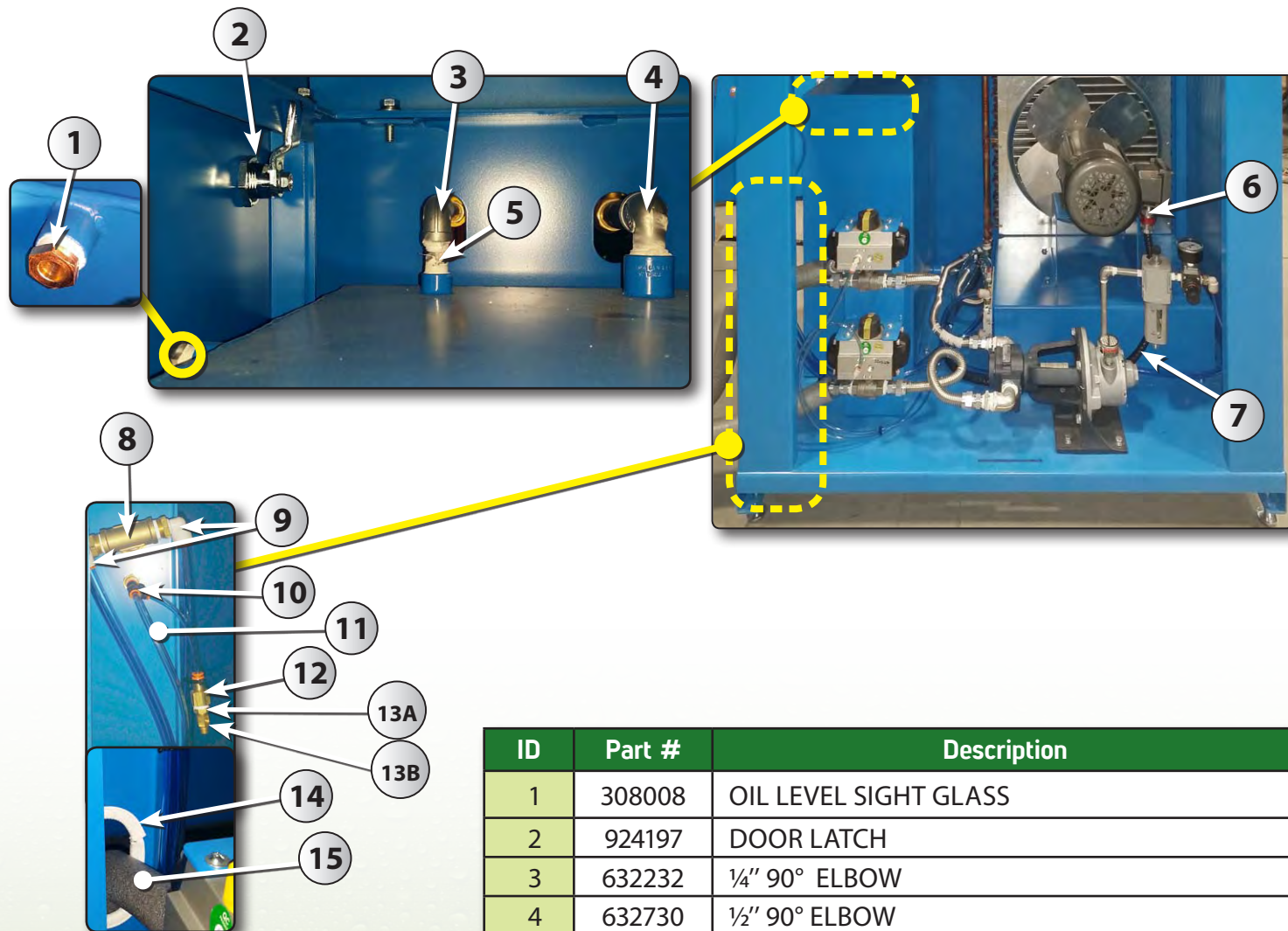

ID	Part #	Description
1	308008	OIL LEVEL SIGHT GLASS
2	924197	DOOR LATCH
3	632232	1/4" 90° ELBOW
4	632730	1/2" 90° ELBOW
5	632202	NIPPLE FITTING 1/4"
6	322004	TECK CONNECTOR 1/2"
7	916602	TECK CABLE 14-3
8	323170	1/2" BRASS "T"
9	314023	PUSH-IN 90° 1/2" NPT X 1/2" TUBE
10	324584	PUSH-IN TEE 1/4" TUBE
11	324571	POLYURETHANE HOSE 1/4"
12	324573	PUSH-IN 1/4" FNPT X 1/4" TUBE
13A	608409	ADAPTER FOR 608408
13B	608408	FLOW CONTROL
14	NPN	FLEXIBLE HOSE GROMMET BAND
15	324585	FLEXIBLE HOSE INSULATION 3' LENGHT

OUTSIDE VIEW - DETAIL PARTS

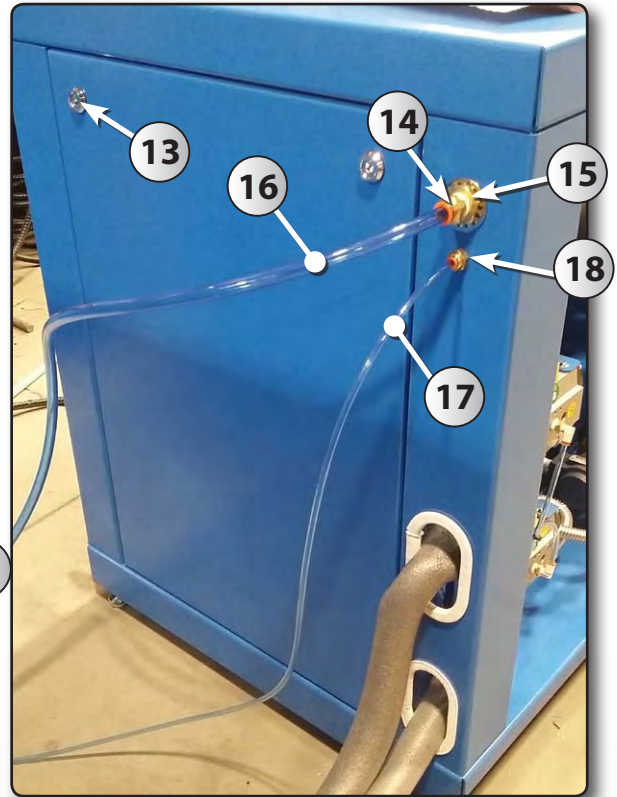
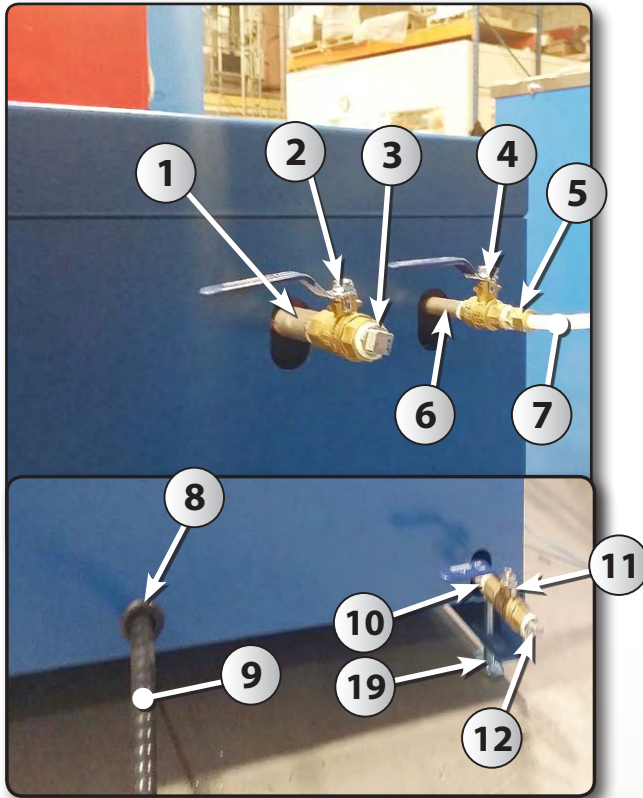

ID	Part #	Description
1	323525	1/2" NIPPLE x 3"
2	608102	1/2" BALL VALVE
3	323522	1/2" PLUG
4	608105	1/4" BALL VALVE
5	323130	1/4" X 3/8" TUBE HOSE CONNECTOR
6	324509	1/4" X 6" NIPPLE
7	324512	3/8" WHITE PVC HOSE
8	618133	GROMMET

ID	Part #	Description
9	916602	TECK CABLE 14-3
10	323525	1/2" X 3" LG. NIPPLE
11	608102	1/2" BALL VALVE
12	323522	1/2" PLUG
13	924197	DOOR LATCH
14	314022	PUSH-IN 1/2" NPT - 1/2" TUBE
15	632741	1/2" BULKHEAD FITTING
16	314025	POLYURETHANE HOSE 1/2"
17	324570	POLYURETHANE HOSE 1/4"
18	314022	PUSH-IN 1/2" NPT - 1/2" TUBE
19	323076	LEVELER

OIL COOLER - CONNEXIONS
Connections and additions to recycler

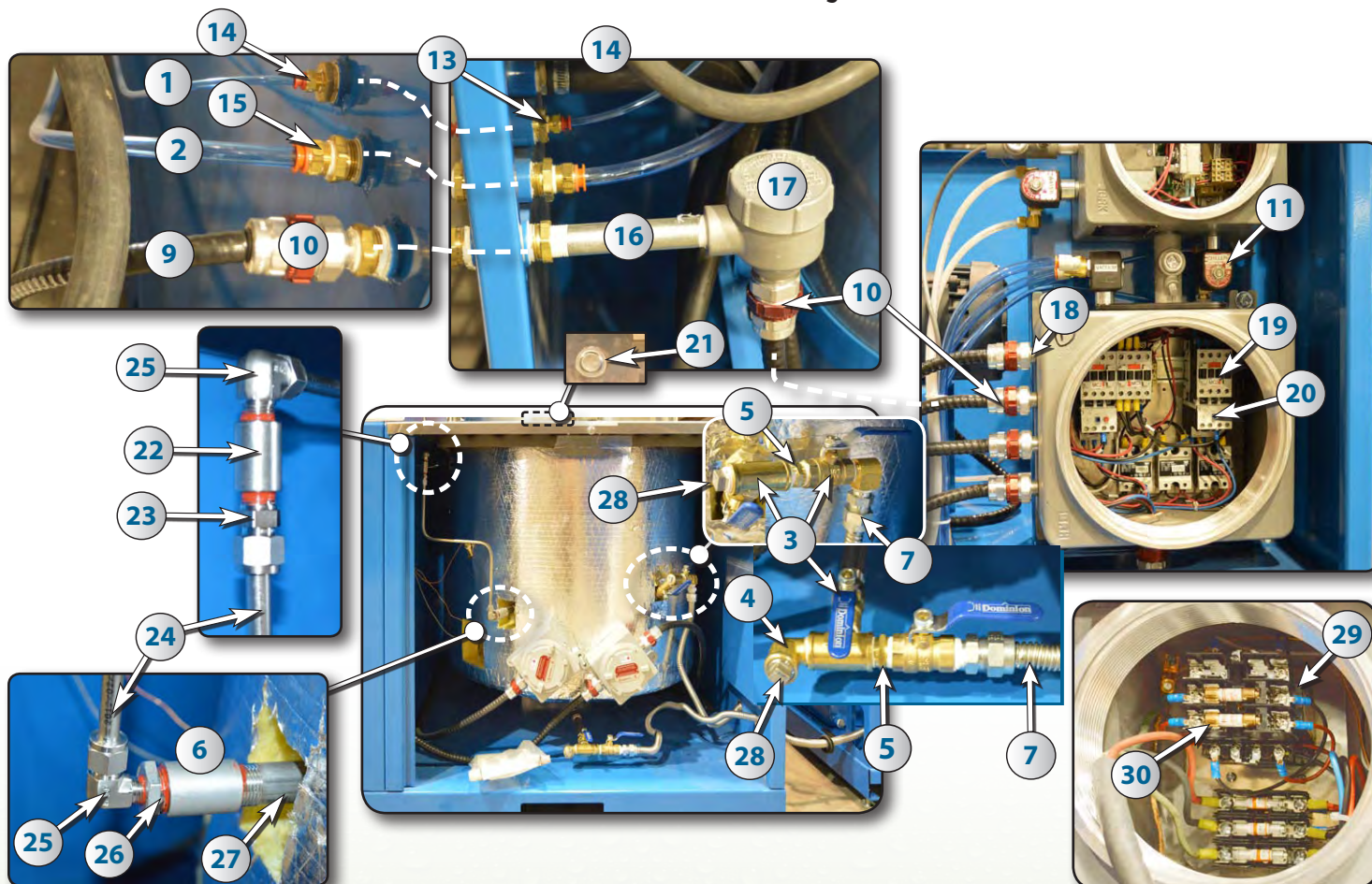

#	STOCK	DESCRIPTION	#	STOCK	DESCRIPTION
1	324570	POLYURETHANE HOSE ¼"	19	314051	CONTACTOR
2	314025	POLYURETHANE HOSE ½"	20	917730	OVERLOAD (480V)
3	608102	BALL VALVE ½"		314076	OVERLOAD (600V)
4	632730	½" 90° ELBOW	21	NPN	CAP
5	632706	½" HEX. NIPPLE	22	323503	¼" UNION
6	323501	½" UNION	23	323238	COMP. S/S FITTING ¼" NPT - ⅜" TUBE
7	323245	GAS CONNECTOR ½" X 60"	24	321039	⅜" S/S TUBE
9	916602	TECK CABLE 14-3	25	323209	90° COMP. FITTING ¼" NPT - ⅜" TUBE
10	322004	TECK CONNECTOR ½"	26	323206	REDUCER S/S ½" X ¼"
11	324003	SOLENOID VALVE	27	323525	NIPPLE ½" X 3"
12	932050	OIL BREATHER	28	323522	PLUG S/S ½"
13	323167	REDUCER ¾" TO ¼"	29	314084	TRANSFO. 480/240V 100VA C/W FUSE AND FUSE HOLDER
14	324558	PUSH-IN ¼" NPT - ¼" TUBE		314085	TRANSFO. 600V/240V 100VA C/W FUSE AND FUSE HOLDER
15	314022	PUSH-IN ½" NPT - ½" TUBE	30	917726	FUSES ATMR 1/2
16	321041	ELECTRIC NIPPLE			
17	322006	JUNCTION BOX			
18	324528	SHAFT COUPLING			

OIL FILLING PROCEDURE

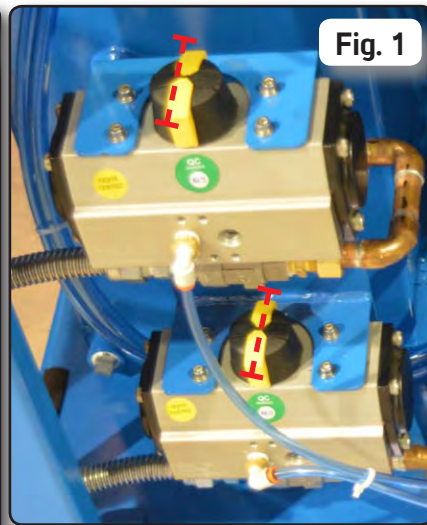

Before you begin, ensure the 2 Rotex valves (Fig. 1) are closed.

- 1.** Start filling the tank by connecting to the ball-valve C1 (Fig. 2) of the oil cooling
- 2.** Fill until to see oil get out of the ball valve C2 (Fig. 2) of the oil cooling
- 3.** Remove your oil supply hose and connect it to the ball-valve of the boiler (Fig. 5)
- 4.** Fill to see oil go up the expansion tank control window (Fig. 6) (Use a flashlight if necessary to see correctly the oil level).
- 5.** Unscrew the 1/4 " plug located on the side of the expansion tank (Fig. 7) and continue to fill until you see the oil flow spill out of it : stop filling and rescrew the plug in place.

Your filling process is now completed.

Remove the plug, and connect here.(the 2 boiler ball-valves must be in open position, but the 2 cooling tank ball valve must be closed to avoid over filling it)

NB : ensure that the oiler pump is always filled with pneumatic oil by checking the level (Fig. 8)

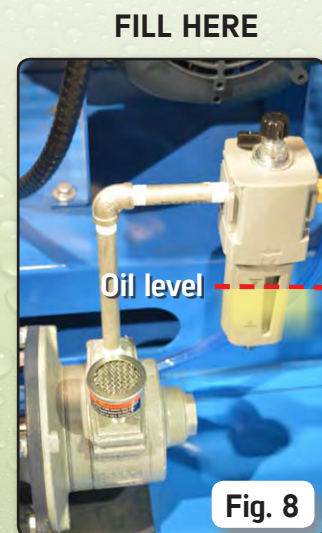
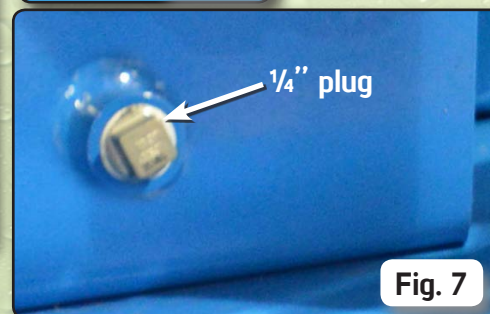

ABOUT THE COMPANY

WHO WE ARE

IST is a leading manufacturer of equipment for the surface treatment industry and the solvent recycling industry. Our extensive line of equipment includes batch units and automated machines designed to achieve the highest manufacturing standards.

MISSION

IST works tightly with their customers to transform industrial processes to improve their quality, productivity, and environmental footprint.

OUR SERVICES

- Custom Design & Fabrication
- Installation & Startup
- Preventative Maintenance Program
- Private Labels
- Testing Lab
- 24/7 Technical Support

INDUSTRIES WE SERVE

- Aerospace & Aviation
- Aluminium Smelters
- Automotive
- Construction & Civil Engineering
- Flexography (labelling) & Lithography
- Foundry & Forge
- General Manufacturing
- Military
- Power & Energy
- Rail & Mass Transit
- Shipyards
- Wood finishing

