

COMPRESSED AIR DRYER D SERIE AND WATER SEPARATOR FSD SERIE

FEATURES

Housings for Flows up to 300 SCFM :

- Heavy duty aluminum casting for high durability and corrosion resistance
- Powder coated exterior for added durability
- Special V-band stainless steel clamps permit easy removal of covers for cartridge replacement
- Optimized air flow through housing minimizes pressure drop
- Wall mounting brackets included
- 3 stages in one unit: separation, filtration and drying

Enhanced Performance: :

- Easy replaceable self-contained desiccant cartridges
- High efficiency polypropylene coalescent elements
- Optimum filter efficiency even at low air flows
- 10 year warranty
- Life expectancy: 25 years
- Pressure dew point: - 40°F
- Max. working pressure: 150 PSIG
- 3 stages in one unit: separation, filtration and drying

HOW IT WORKS

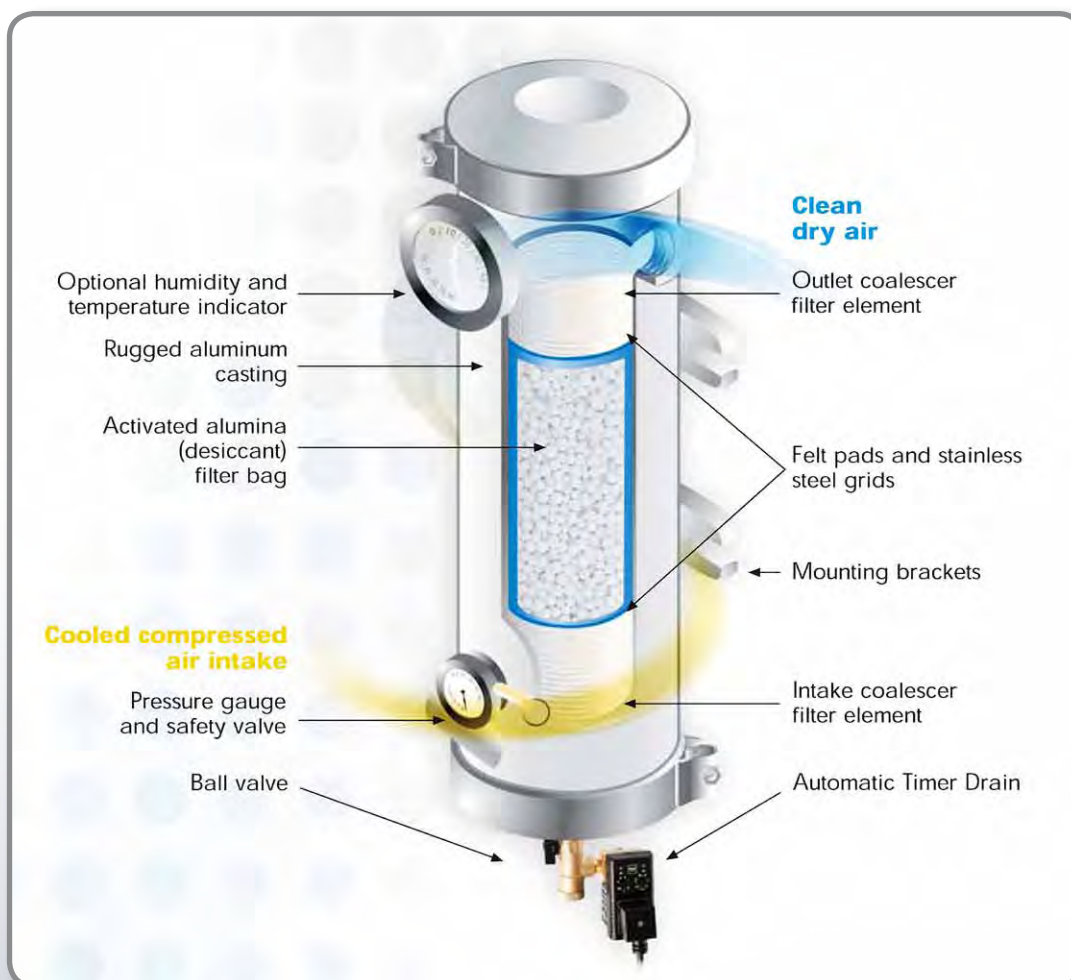

Super-Dry Compressed Air Dryers contain two highly efficient polypropylene coalescer elements at inlet & outlet ports to absorb oil and all solid air particles. Also included, one desiccant bag specifically designed to absorb water vapors and humidity from your compressed air system.

OPTIONS



1	Temperature and Moisture Indicator Indicates optimum cartridge replacement based on % relative humidity
2	Ball Valve & Strainer Isolates and protects drain
3	Automatic Timer Drain Efficient drainage of condensate Extends the cartridge life of the dryer

STANDARD ACCESSORIES



Pressure Gauges, Safety Valve and Ball Valve



Replacement Cartridge

TYPICAL CONFIGURATIONS & INSTALLATIONS

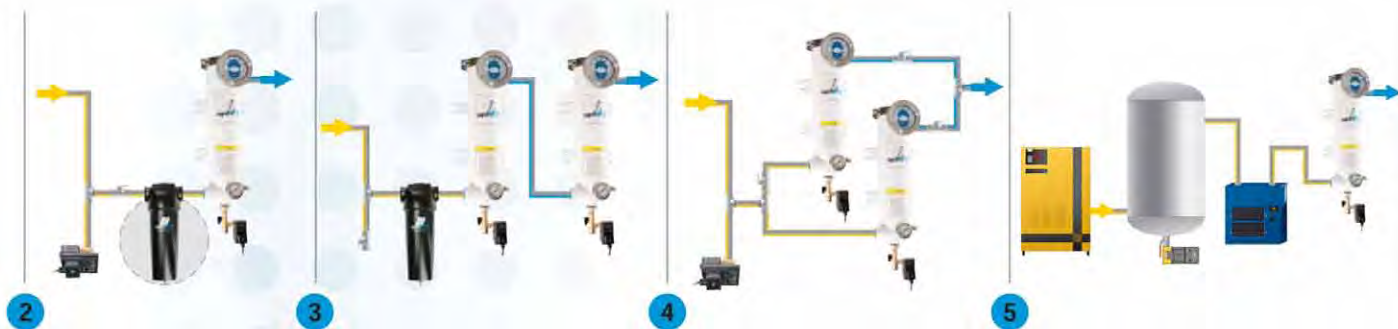
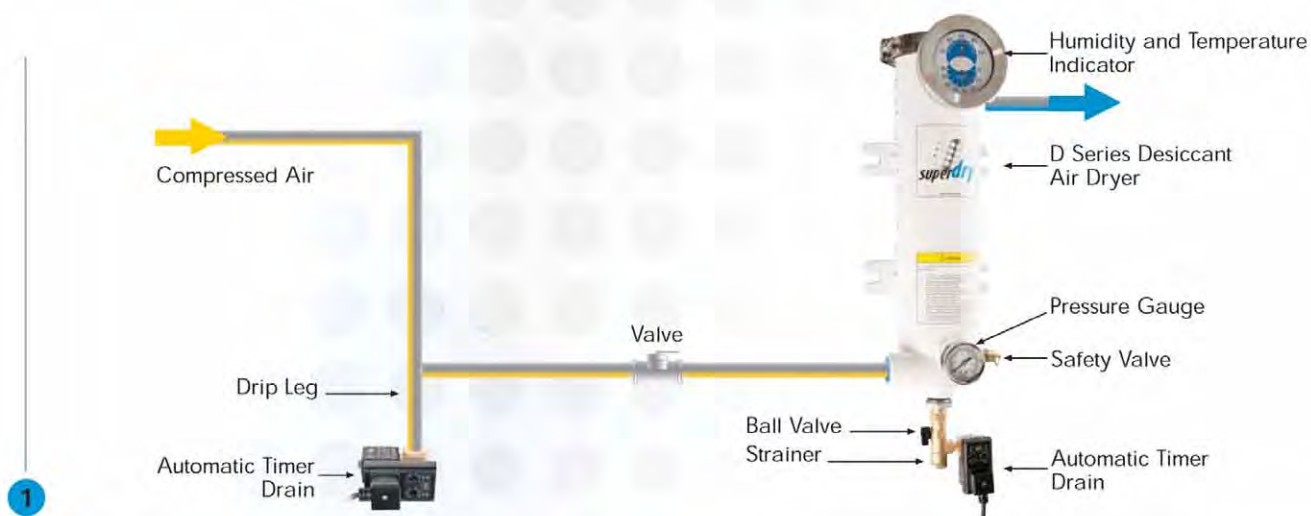

1 Recommended Configuration

- General Shop Air
- Air Tools
- Sand Blasting

2 Air / Water Separator

- Extends the life of the desiccant cartridge

3 In Series Configuration

- Provides a stable dew point

4 Parallel Configuration

- Recommended for high flows
- Maintenance without interrupting the air supply

5 Downstream of a refrigerated air dryer

- Provides lower dew point



SPECIFICATIONS

Specifications and ordering information:

Model	Air Flow @ 100 psig	Inlet/Outlet NPT	Dimensions			Weight	Replacement Kit
	scfm	in	A	B	C	lbs	
			in				
D-1	70	1	6	19	17 ½	20	ED-1
D-2	150	1 ½	9	20	18	40	ED-2
D-3	200	2	9	33	30	75	ED-3
D-4	300	3	11	33	29 ½	100	ED-4

Maximum inlet temperature: 100° F (38°C) Maximum inlet pressure: 150 psig

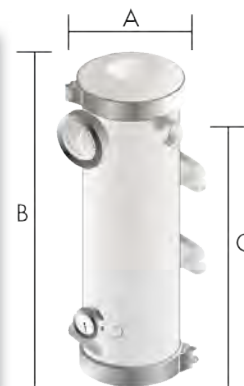

Part number

#	STOCK	DESCRIPTION
D1	611101	DRYER AIR 70 cfm 1" NPT
D2	611102	DRYER AIR 150 cfm 1½" NPT
D3	611103	DRYER AIR 200 cfm 2" NPT
D4	611104	DRYER AIR 300 cfm 3" NPT

Options

Humidity and Temperature Indicator HGT- ¼		Automatic Timer Drain TD- ¼		Ball Valve Strainer BVS- ¼	
HGT - ¼	Relative Humidity % 10 - 80	Temperature °F 20 - 100		Connection NPT ¼	
TD - ¼	Interval Time min. 0.5 - 45	Discharge Time sec. 0.5 - 10		In & Out Ports NPT ¼	
BVS - ¼	Inlet Port NPT ½	Outlet Port NPT ¼		Material Brass	

WATER SEPARATOR TYPE FSD



Configuration and Installation



Typical applications

- Protection of refrigeration dryer
- Pre-filtration of desiccant dryer
- Bulk liquid removal at the point of use
- Downstream of an after-cooler
- Protection of compressed air piping and air receivers from corrosion

#	STOCK	DESCRIPTION
FSD-60W	611049	MOISTURE SEPARATOR ½"
FSD-80-W	611055	MOISTURE SEPARATOR 1"
FSD-100-W	611103	DRYER AIR 200 cfm 2" NPT
FSD 180-W	611104	DRYER AIR 300 cfm 3" NPT
5		

Specifications and ordering information:

Model	Air Flow @ 100 psig scfm	Inlet/Outlet NPT in	Dimensions			Weight lbs
			A	B	C	
FSD-60-W	85	½	3.8	9.3	7.9	3
FSD-80-W	85	¾	3.8	9.3	7.9	3
FSD-100-W	233	1	5.1	10.8	9.2	5
FSD-180-W	233	1 ¼	5.1	10.8	9.2	5
FSD-300-W	742	1 ½	6.7	17	15	12
FSD-400-W	742	2	6.7	17	15	12
FSD-500-W	1695	3	8.1	19.9	17.5	22

Maximum inlet temperature: 176°F (80°C) Maximum inlet pressure: 232 psig

