

Extrusions Sandblasting



Customers who have these systems installed :
Isothermic Doors and Windows – Munroe

MARKETS

- General manufacturing
- Aerospace and aviation
- Marine
- Automotive
- Petroleum
- Power & energy
- Pharmaceutical

TECHNICAL FEATURES

- ✓ Short processing times
- ✓ Long head and nozzle service life
- ✓ High blasting performance
- ✓ Abrasion resistant piping system (Urethane)
- ✓ Easily accessibility for the replacement of spare parts
- ✓ Direct drive, reduced wear and tear of parts, such as the bearing block lower noise levels
- ✓ A rubberized layer protects the front door window against abrasives.
- ✓ Heavy Duty construction and welded steel frame
- ✓ Short spare part delivery times
- ✓ Design allows for the integration of robot units for fully automatic loading and unloading
- ✓ Available with 4-6-8 or 12 adjustable nozzles for optimal blasting results
- ✓ Automated system ensures consistent and reliable sandblasting results of complex parts.
- ✓ Processing of long components (profiles, beams) is possible, as well as the secure blasting of small components and parts
- ✓ Easily integrated into existing production lines
- ✓ Used blast media is recycled via a cyclon separator that can be equipped with an optional magnetic particle separator
- ✓ Large separated particles can be further screened via a rotating drum

AUTOMATIC SANDBLASTING CABINET WITH INLINE CONVEYOR

ISTblast deflashers functions with high efficiency in integrated manufacturing cells, where similar parts or families of parts are molded and finished within the stringent quality and time constraints of just-in-time manufacturing.

The compact design ensures that the Inline systems can be installed and operate next to molding presses or integrated within an existing conveyor system. Automatic or semi-automatic operation eliminates the need for hand finishing and leads to increased levels of production and quality. Available in adjustable mesh belt, double belt, and other parts handling configurations, the ISTblast deflashers comes standard with a dust collector and an air knife. ISTblast provides flexibility and versatility that meet today's requirements for on-demand production with no sacrifices in quality.

Equipped with a powerful induction feed suction blasting system, the ISTblast deflasher assures that finished parts that are clean and dust-free. Units come with a free-standing dust collector and external cyclone with an adjustable separator for media reclamation. For high volume use, a pulse-type dust collector provides continuous filter cleaning. An optional high pressure air blow system can be equipped to ensure a maximum amount of shop cleanliness.

Open weave mesh belt models allow parts to be blasted from all angles. Wide spaces between links allow blasting from below the parts. Single point gun swivels can be adjusted for any angle and allow quick conversion for different parts. To accommodate a wide variety of part configurations, unique single or parallel part guides can be easily adjusted to any size or to form multiple tracks. Belt widths, mesh sizes and wire thicknesses can be selected to suit any size and strength requirements.

The In-Line Machines process parts on a continuous basis. These machines accept and unload work pieces handled manually or automatically. The ISTblast In-Line systems can be equipped with either suction or pressure blast systems and the guns can be fixed or variable. These units can be custom engineered to meet your production requirements.

HOW IT WORKS

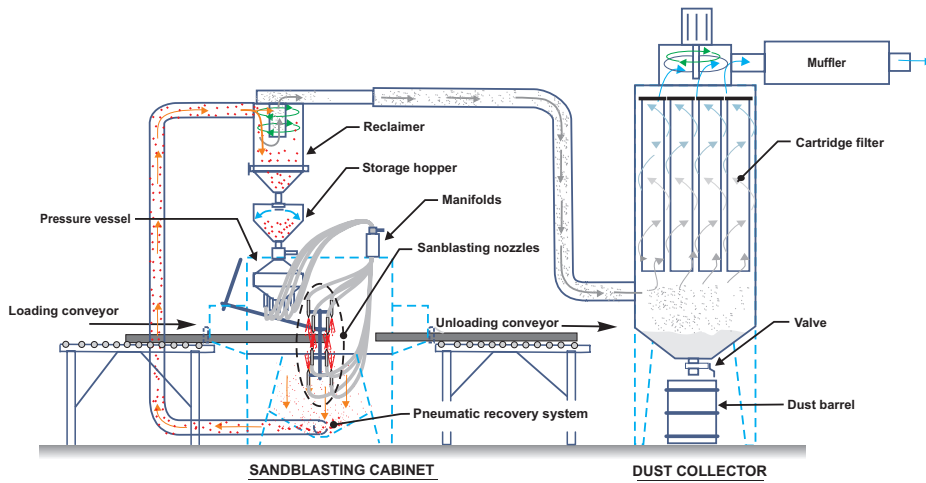

FLOOR PLAN

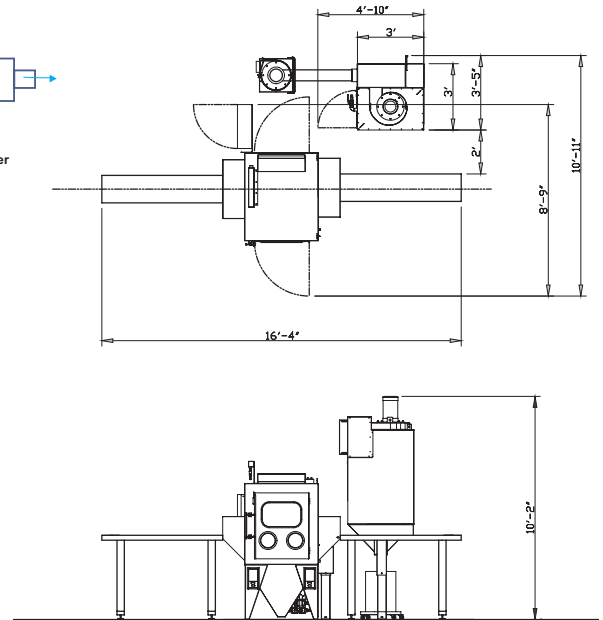

DETAILS

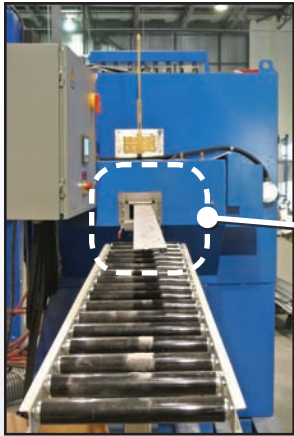

Conveyor

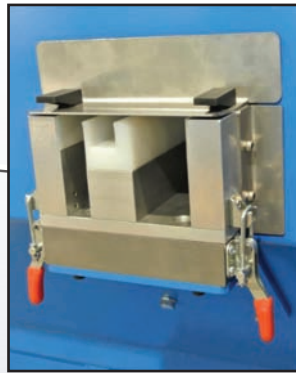

Extrusion entry rails

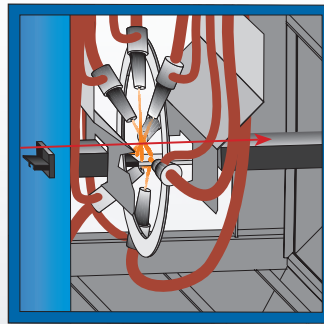

Sandblasting nozzles

Inside cabinet

- Lined with rubber to protect housing against abrasion.
- Several suspended rubber curtains help to prevent the exit of blasting media.
- Manually operable service doors are protected by safety switches to prevent accidental opening during machine operation.

AVAILABLE OPTIONS



Loading/offloading system

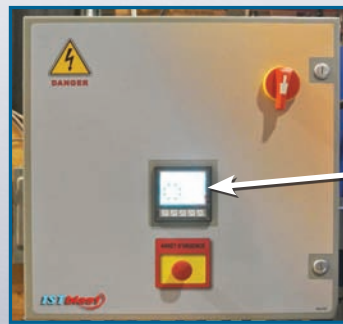

Control panel with HMI*

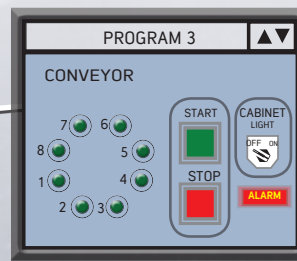

HMI* touchscreen control

*HMI : Human Machine Interface