



## RESPIRATORY PROTECTION

The airline respirator Series offer comfortable, reliable respiratory protection for abrasive blasters and painters. Our systems are NIOSH approved as Type C or CE Continuous Flow Class Respirator (Approval No. TC-19C-293).

Basically, there are three types of air feeding system to supply your air fed protective hood:

- **Option A - Air purifying system:** A Radex filtration system using a carbon filter and activated alumina will remove 98% of particles down to 0,5 micron size. Does not remove carbon monoxide or other gases from airlines.
- **Option B - Grade "D"\* Air Supply with carbon monoxide detector:** A Radex filtration system combined with a 4-step filtration system will efficiently remove oil, dust, odors, organic vapors, water and other contaminants, and provide Grade "D" Air according to OSHA. This system is also equipped with a carbon monoxide detector and warning signal.
- **Option C- Ambient Air Supply:** A breathing air system using a room air pump model EDP-10 to supply ambient air to the hood. The pump is activated by an electric motor with a power of 3/4 hp and 10 cubic feet @ 10 lb / pc.

These three assemblies are provided with pressure regulator for controlling supplied air to blasting hood and are considered the safest means to provide quality breathing air to the operator.

\* Compressed breathing air shall meet at least the requirements for Grade D breathing air described in ANSI/Compressed Gas Association Commodity Specification for Air, G-7.1-1989

### AIR FED PROTECTION HOODS

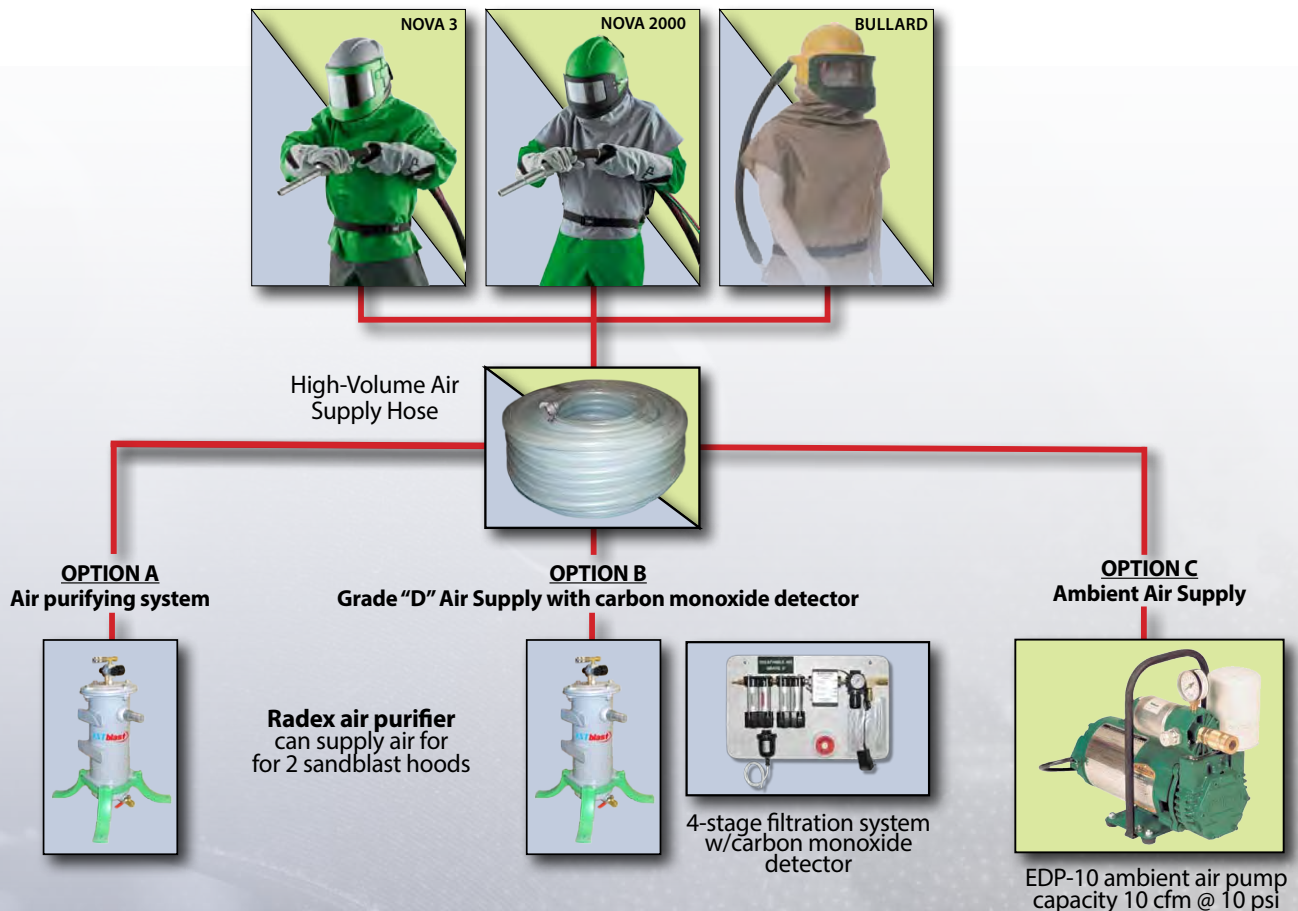



## TABLE OF CONTENTS

	PAGE
NOVA 3 HOOD .....	3
NOVA 2000 HOOD .....	4
BULLARD (88 VX) HOOD .....	5
RADEX AIR PURIFIER .....	6
4-STAGE FILTRATION SYSTEM MODELS 50.....	7
4-STAGE FILTRATION SYSTEM MODELS 80.....	8
4-STAGE FILTRATION SYSTEM MODELS 150.....	9
4-STAGE FILTRATION SYSTEM MODELS (MISCELLANEOUS).....	10
EDP-10 AMBIENT AIR PUMP.....	11
ABOUT THE COMPANY .....	12



## NOVA 3 HOOD

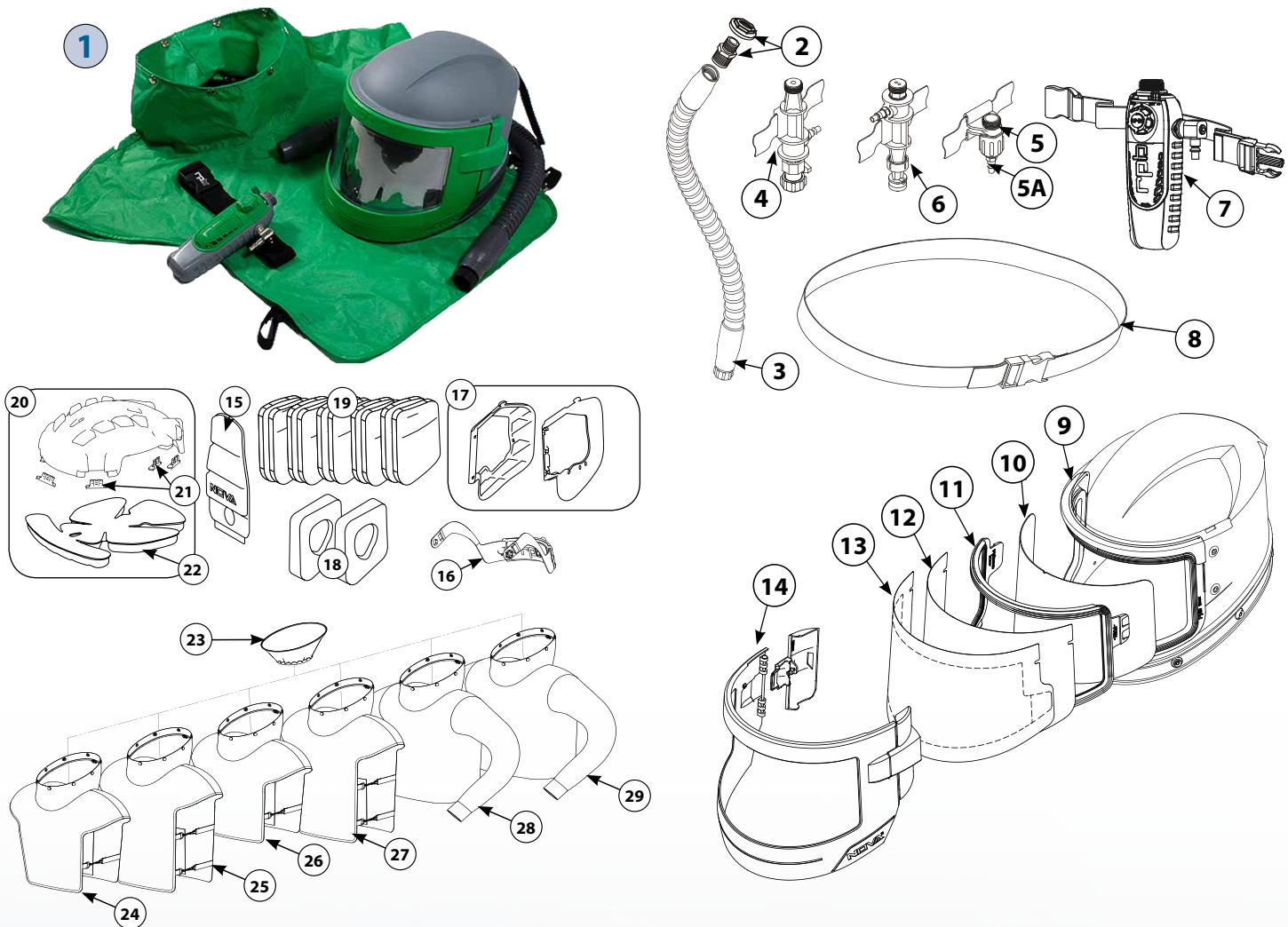

#	STOCK	DESCRIPTION
1	603544	COMPLETE NOVA 3 WITH FLOW CONTROL
2	603522	AIR INLET KIT
3	603515	BREATHING TUBE
4	603533	HOT AIR TUBE C/W BELT
5	603516	FLOW CONTRÔLE VALVE ASS'Y C/W BELT
5A	603519	QUICK CONNECT FITTING ¼" MNPT
6	603538	COLD AIR TUBE C/W BELT
7	603555	CLIMATE CONTROL TUBE
8	603521	BELT
9	603556	INNER GASKET
10	603550	INNER LENS (PACK OF 10)
11	603557	INNER LENS FRAME
12	603541	OUTER LENS (PACK OF 50)
13	603540	TEAR OFF LENS (PACK OF 50)
14	603558	VISOR KIT - INCLUDES: VISOR WITH HINGE PIN AND LATCH, HINGE LOCK

#	STOCK	DESCRIPTION
15	603559	HEAD LINER PADDING
16	603560	ADJUSTABLE HEAD SUPPORT
17	603561	SIDE PADDING FRAMES
18	603562	SIDE PADDING FOAM PADS (LEFT & RIGHT)
19	603563	SIDE PROTECTION COVERS (5 PAIRS)
20	603564	HEAD LINER KIT, INCLUDES: HEAD LINER, FOAM PADDING, CLIPS (X4)
21	603565	HEAD LINER CLIPS, PACK OF 4
22	603566	HEAD LINER PADDING
23	603567	INNER BIB
24	603568	28" NYLON CAPE
25	603569	38" NYLON CAPE
26	603570	28" LEATHER CAPE
27	603571	38" LEATHER CAPE
28	603572	BLAST JACKET EXTRA (XL)
29	603573	BLAST JACKET (XXL)



### NOVA 2000 HOOD

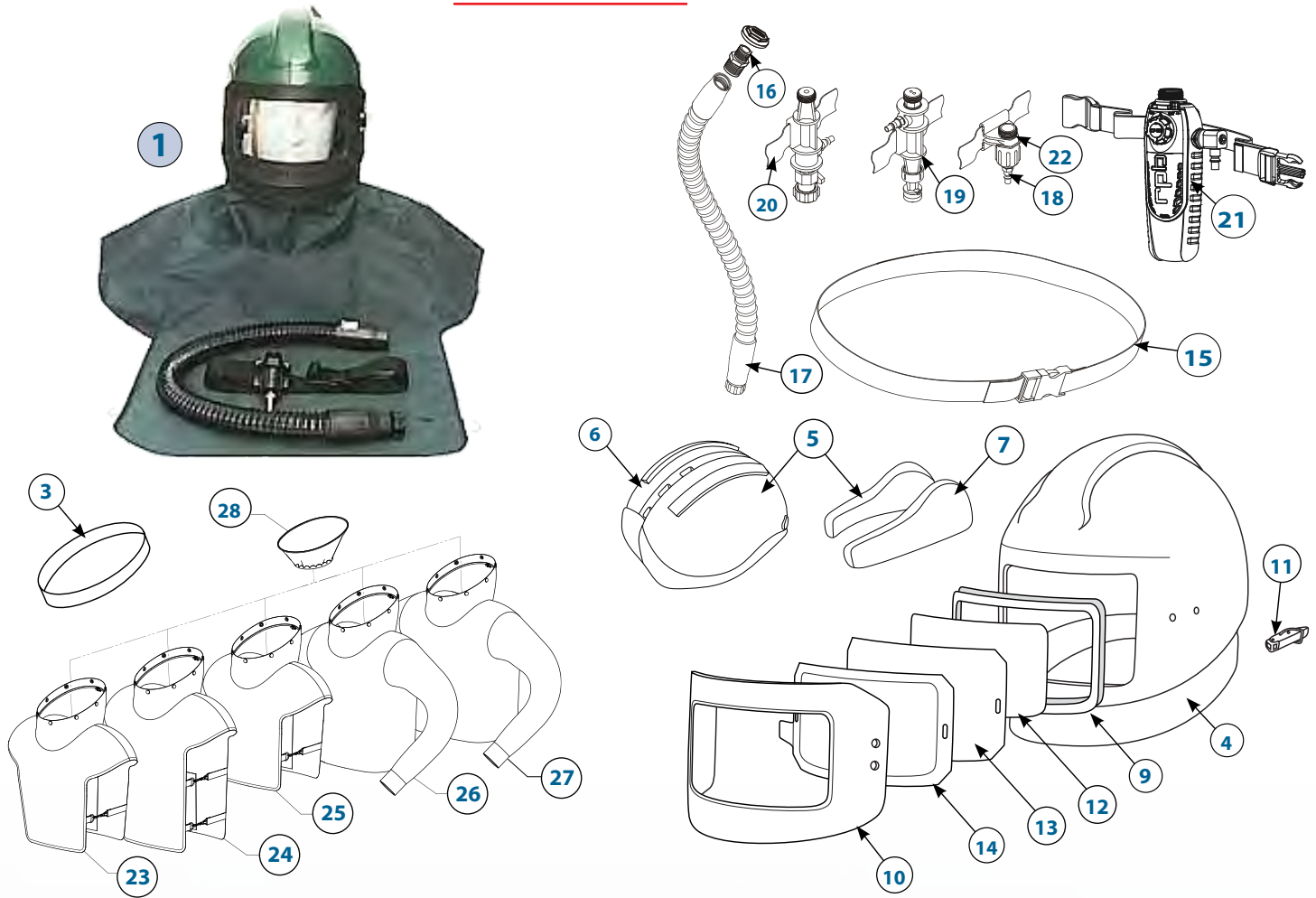

#	STOCK	DESCRIPTION
1	603500	COMPLET NOVA 2000 KIT
3	603502	INNER SHUTTLE
4	603503	CAPE STRIP
5	603517	CONE FOR HAT & SIDE PADDING (LARGE)
	603530	CONE FOR HAT & SIDE PADDING (MEDIUM)
	603531	CONE FOR HAT & SIDE PADDING (SMALL)
6	603504	CONE FOR HAT
7	603505	SIDE PADDING
8	603506	QUICK CONNECT 3/8" MNPT
9	603507	DOOR SEAL
10	603508	VISOR
11	603509	BRACKET & NUTSS
12	603514	INNER VISORS (PACK OF 10)
13	603512	OUTER VISORS (PACK OF 50)
14	603513	REMOVABLE VISORS (PACK OF 50)

#	STOCK	DESCRIPTION
15	603521	BELT & LOOP
16	603522	AIR INLET KIT
17	603515	BREATHING HOSE
18	603519	1/4" MNPT QUICK CONNECT FITTING
19	603538	COLD AIR TUBE WITH MBSP THREAD & BELT
20	603533	HOT AIR TUBE WITH MBSP THREAD & BELT
21	03-500	TEMPERATURE CONTROL TUBE
22	603516	FLOW CONTROL VALVE WITH BELT
23	603520	NYLON CAPE 28"
24	603539	NYLON CAPE 38" XL
25	NV2002L	LEATHER CAPE 28"
26	NV2002HB-XL	LEATHER CAPE 38" XL
27	NV2002HB-XXL	BLASTING JACKET XXL
28	NV2012	INNER BIB



**BULLARD (88 VX) HOOD**

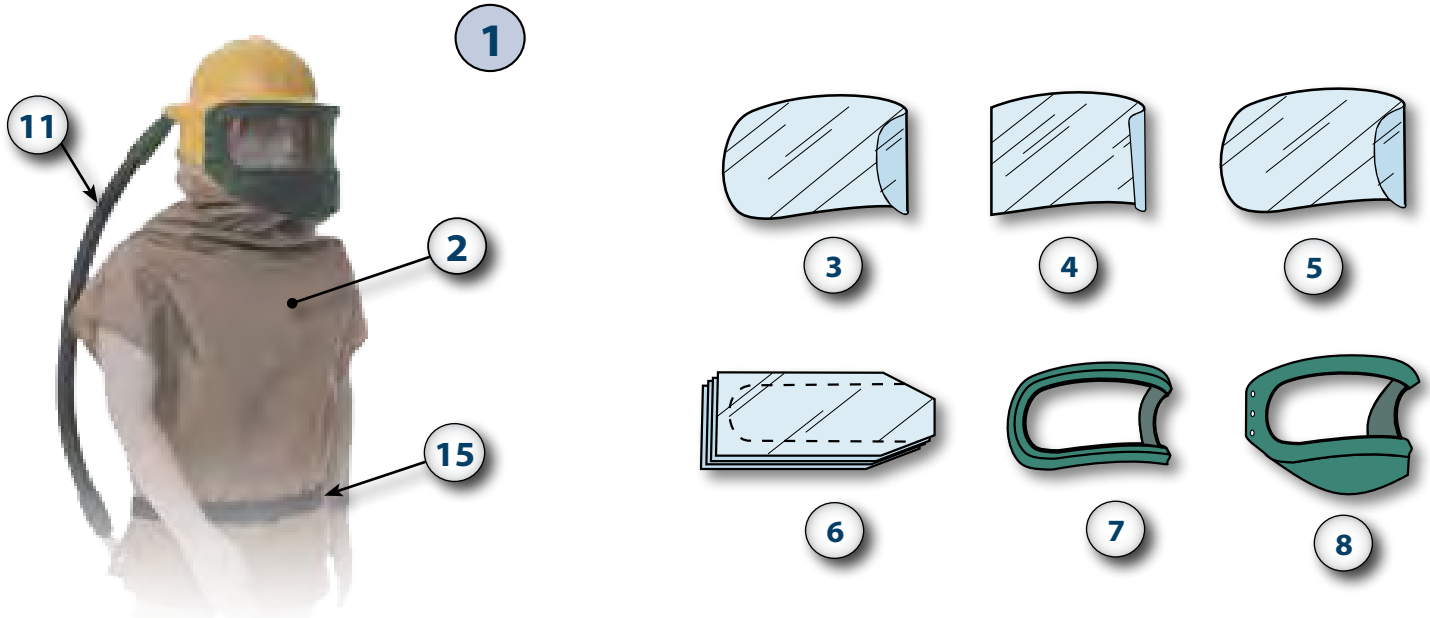

1	603070	AIR FED HOOD 88VX BULLARD. HOOD - CAPE - HOSE & BELT (2-11-15)
	613211	NYLON CAPE (STANDARD 28" LENGTH)
2	613224	CAPE LENGTH 38"
	613237	HIBERNIA NYLON CAPE (38" LENGTH)
3	613009	RPW6 INNER SHIELD (OVAL 4 1/2" X 12 3/4")
4	613010	RPW6 - OUTER SHIELD (RECTANGULAR 5" X 14")
5	913004	RPW6 - OUTER SHIELD OVAL (4 1/2" X 14")
6	613234	BH8/BH6 77LC PERFOR. VISOR SHIELD (PACK OF 25)
7	613205	WINDOW GASKET INCLUDING SEAL AND VISOR
8	613254	OUTER WINDOW FRAME KIT

9	613132	STANDARD HEADBAND SUSPENSION
	613134	RATCHET HEADBAND SUSPENSION
10	613139	CHIN STRAP
11	613226	BREATHING TUBE ONLY
12	613232	F30 1/2" BELT ADAPTOR
13	613229	FLOW CONTROL VALVE AND ADAPTOR
14	613238	BH8/BH30 FA35 1/2" BELT ADAPTOR
15	613212	BELT
16	613235	AC1000 AIR COOLER HOSE



## HOT AND COLD AIR TUBES

Maximize operator comfort and productivity by cooling or warming the breathable air supplied to the hood.

### ACCESSORY INSTALLATION



1



Warms the respirator air inlet to a respirator up to 30 ° F (17 ° C). The NV4000 Hot Air Tube Assembly helps maximize worker comfort and increase productivity when used in cold climates.

The NV4000 is made from non-toxic engineering plastics that are extremely robust and highly resistant to the rigors of the workplace.

\* Do not use with low pressure systems.

2



Cools breathing air intake from respirator to 32 ° F (18 ° C). The NV4000 Cold Air Tube Assembly helps maximize worker comfort and increase productivity when used in hot climates.

The NV4000 is made from non-toxic engineering plastics that are extremely robust and highly resistant to the rigors of the workplace.

\* Do not use with low pressure systems.

### OTHER HOSE ACCESSORIES



1	603511	HOT AIR TUBE WITH MBSP THREAD & BELT
2	603510	COLD AIR TUBE WITH MBSP THREAD & BELT
3	613155	COLD AIR TUBE "AC1000"
4	613233	COLD AND HOT AIR TUBE HC2400
5	613160	FLOW CONTROL VALVE 1/2" WT MUFFLER

### AIR SUPPLY HOSE

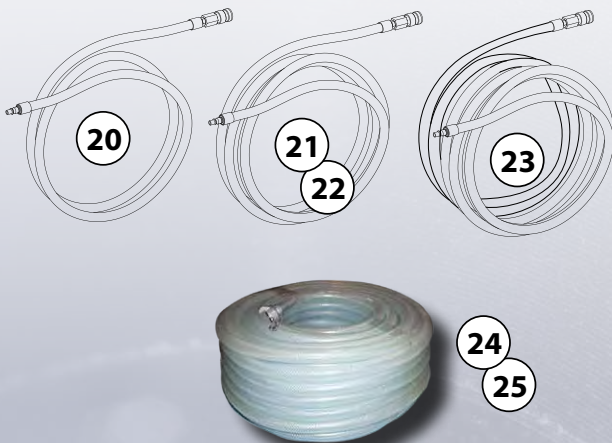

20	613144	25' ISTBLAST STARTING HOSE C/W CONNECTORS
21	606145	50' ISTBLAST STARTING HOSE C/W CONNECTORS
22	606142	50' ISTBLAST EXTENSION HOSE C/W CONNECTORS
23	606143	100' ISTBLAST EXTENSION HOSE C/W CONNECTORS
24	603526	50' - 1/2" HOSE C/W CONNECTORS FRO AMBIENT AIR PUMP
25	603527	100' - 1/2" HOSE C/W CONNECTORS FRO AMBIENT AIR PUMP



## RADEX AIR PURIFIER

Les purificateurs d'air Radex sont conçus pour éliminer 98% des particules jusqu'à 0.5 micron contenu dans l'air. Les purificateurs d'air pour cagoule ISTblast peuvent être utilisés en combinaison avec d'autres appareils de protection afin de fournir un air plus propre aux cagoules alimentées en air et autres systèmes pneumatiques. Cependant, il n'élimineront pas le monoxyde de carbone et autres gaz toxiques.

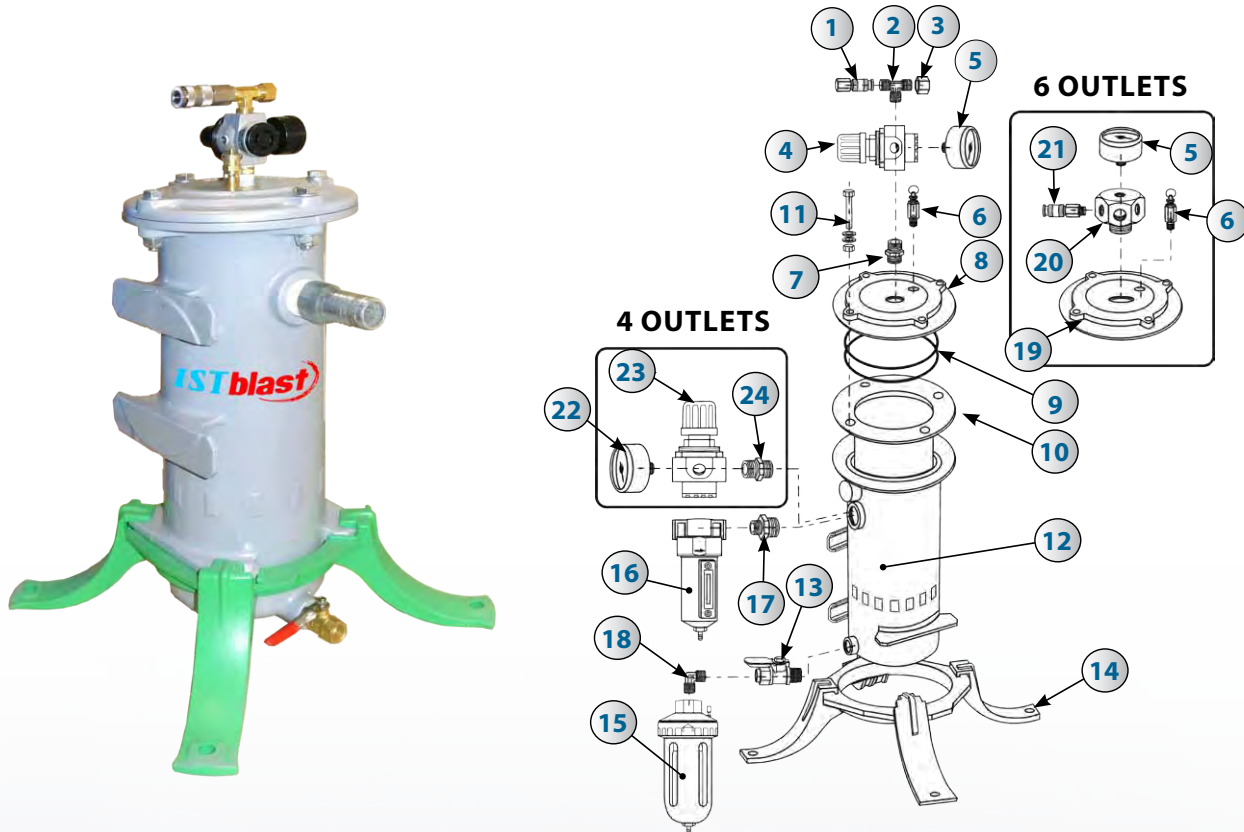

#	STOCK	DESCRIPTION
<b>A</b>	<b>603600</b>	<b>RADEX FILTER ASSEMBLY</b>
1	603601	QUICK RELEASE COUPLER, FEMALE THREAD, 3/8"
2	603602	TEE, BRASS, 3/8"
3	603603	CAP, BRASS, 3/8"
4	603604	PRESSURE REGULATOR, LESS GAUGE
5	603605	PRESSURE GAUGE
6	603606	VALVE, PRESS RELIEF, 125 PSI, 1/4" NPT
7	603607	HEX NIPPLE, BRASS, 3/8"
8	603608	FILTER LID
9	603609	"O"- RING, SET OF 2
10	603050	FILTER CARTRIDGE, FLANGED
11	603611	BOLT, NUT, WASHER, SET OF 4
12	603612	FILTER BODY

#	STOCK	DESCRIPTION
13	603613	DRAIN TAP, BRASS, 1/4" NPT
14	603614	BASE MOUNT
15	603615	AUTO DRAIN UNIT, 1/4" NPT
16	603616	MICRO MIST FILTER 1/2" ASSEMBLY
17	603617	REDUCING NIPPLE, BRASS, 1" X 1/2"
18	603618	ELBOW, BRASS, 1/4"
19	603619	SIX OUTLET FILTER LID
20	603620	6 OUTLET MANIFOLD
21	603621	COUPLERS
22	603622	PRESSURE GAUGE
23	603623	SUPER HIGH FLOW REGULATOR
24	603624	CONNECTOR, 1" NPT



### 4-STAGE AIR FILTRATION SYSTEM MODELS 50 TO 150

The 4-stage filtration systems from Type 50 to 150 are designed to provide 50 to 150 scfm of grade D purified breathable air from your existing compressed air supply. These systems are equipped with a broadband monitor, four-stage filtration, and automatic float trap.

Our filtration systems are mounted on a panel and are available in fixed and portable versions. They are ready in one minute thanks to their heating system and are equipped with warning and audible warning lamps to alert the operator when the quantities of toxic gases exceed the predefined OSHA limits.

#### FEATURES

- ✓ Compressed air option
- ✓ Designed to provide grade D air quality
- ✓ Optional accessories: hood, mask, etc.

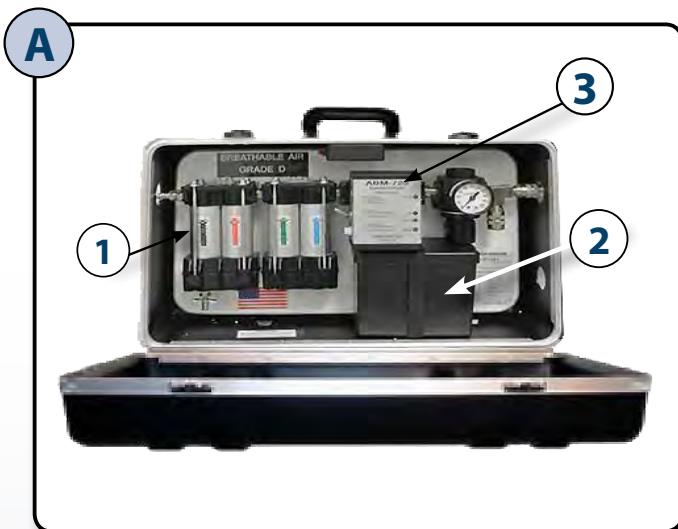

Portable

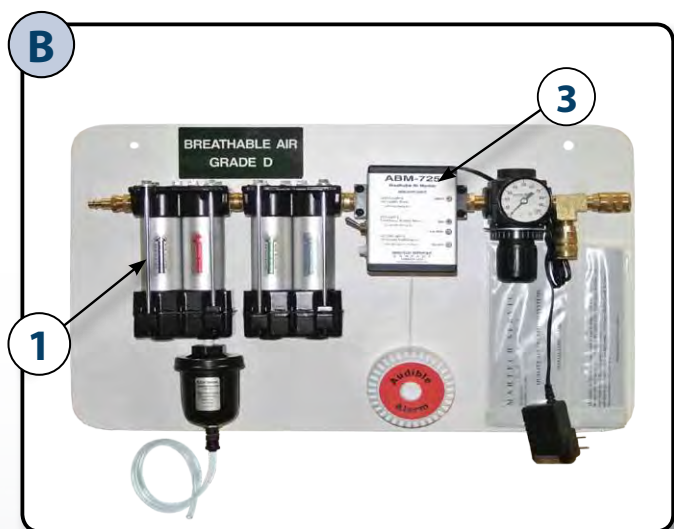

Stationary

A	603116	50 cfm portable filtration kit
B	903104	50 cfm stationary filtration kit
1	603117	Replacement filter kit
2	603123	Rechargeable battery
3	603118	Carbon monoxide detector
*	603119	(not illustrated) Calibration kit







## 4-STAGE FILTRATION SYSTEM MODELS 50

The Model 50 Systems are designed to provide 50 SCFM of Grade “D” Breathable Air, from your existing compressed air supply. These complete systems are panel mounted and available in both stationary and portable versions. All Model 50 Systems are outfitted with a broad range monitor, four-stage filtration, and auto float drain. With warm up purge cycle time of only one minute, these systems are ready, quickly. Built in warning lamps and audible horn alert users if hazardous gases exceed the preset OSHA limits.

### MODEL 50-2

Is designed to support two supplied air respirators at the same time. This affordable panel mounted system comes complete with two output quick couplers. The pressure regulator is user set in the NIOSH approved respirator guidelines. These systems are available with electronic air powered audible horns.



### MODEL 50-4

Is designed to support up to four supplied air respirators at the same time. This affordable panel mounted system comes complete with a larger pressure regulator and four output quick couplers, manifold mounted. These systems are available with electronic or air powered audible horns.

### MODEL 50-P

Is available in two and four output versions. These affordable portable systems are mounted in a lockable, rugged case made of strong materials to withstand rough handling. These battery-operated systems can provide service whenever compressed air is available. These systems are available with electronic, or air powered audible horns. Both internal and external indicator lamps are a standard feature.





## 4-STAGE FILTRATION SYSTEM MODELS 80

The **Model 80 Systems** are designed to provide 80 SCFM of Grade “D” Breathable Air, from your existing compressed air supply. These complete systems are panel mounted and are available with two types of on-board monitors to choose from. Both monitors provide a warm up purge cycle time of only one minute. The four-stage filtration and automatic moisture discharger are standard. Built in warning lamps and audible horn alert users if hazardous Bases exceed preset OSHA limits.

### MODEL 80-B

is available with either no output quick couplers, for onsite plumbing, or up to eight output quick couplers. This “B” style monitor system provides broad range protection, with both audible horn and analog display. User friendly indicator lamps will advise operator the status of the system at a glance.



### MODEL 80-E

is available with either no output quick couplers, for on site plumbing, or up to eight output quick couplers. This “E” style monitor system provides electro chemical cell sensor technology, with both audible horn and digital display. Userfriendly indicator lamps will advise operator the status of the system at a glance.



## 4-STAGE FILTRATION SYSTEM MODELS 150

The Model 150 Systems are designed to provide 150 scfm of Grade "D" Breathable Air, from you existing compressed air supply. These complete systems are panel mounted and are available with two types of on-board monitors to choose from. Both monitors provide a warm up purge cycle time of only one minute. The four-stage filtration and automatic moisture discharge are standard. Built in warning lamps and audible horn alert users if hazardous gases exceed the present OSHA limits.

### MODEL 150-B

System is available with either no output quick couplers, for on-site plumbing, or up to twelve output quick couplers- This "B" style monitor system provides broad range protection, with both audible horn and analog display. User-friendly indicator lamps will advise operator the status of the system at a glance.



### MODEL 150-E

Is available with either no output quick couplers, for on-site plumbing, or up to twelve output quick couplers. This "E" style monitor system provides electro chemical cell sensor technology, with both audible horn and digital display- Userfriendly indicator lamps will advise operator the status of the system at a glance.

## OSHA & CSA REGULATIONS :

This table will show the maximum allowable contaminant levels as regulated by OSHA and CSA. All ISTblast Services Company's systems are designed to comply with these regulations.

CONTAMINANT	OSHA	CSA
Carbon Monoxide (CO) by volume	10 ppm	5 ppm
Carbon Dioxide (CO <sub>2</sub> ) by volume	1000 ppm	500 ppm
Hydrocarbons (condensed) by weight	5 mg/m <sup>3</sup>	1 mg/m <sup>3</sup>
Hydrocarbons (gaseous) by volume	N/A	55 ml/m <sup>3</sup>
Odor	Slight	not detectable



**4-STAGE FILTRATION SYSTEM MODELS (MISCELLANEOUS)**

Carbon monoxide (CO) when compressed, becomes a very toxic air contaminant. It reduces the ability of the red blood cells to carry the necessary oxygen to the body tissues. This potentially dangerous condition is extremely hazardous. When you consider that carbon monoxide is absorbed twice as fast as oxygen. This is true even when the supply of oxygen is abundant. Air breathing air compressors can intake carbon monoxide and other contaminants. Therefore, it is imperative and required that air supplied breathing air be properly monitored.



**MODEL 50 SL SYSTEM**

is a complete panel mounted system. This system is designed to provide a single user with Grade "D" Breathable Air, and comes with a 35' single line hose assembly that includes a 54" tool hose. The broad range monitor along with the four-stage filtration and auto float drain are standard features. This system is also available with a 50' single line hose assembly.



**THE P-20, PABU**

is a belt-mounted filter and monitor system designed to provide Grade "D" Breathable Air protection for one person. This lightweight unit works in conjunction with clean compressed air. The built in pressure regulator and gauge shows the user to set the appropriate pressure for a NIOSH approved respirator. A 54" tool hose is shipped with the unit to show for a single line hose system.

**THE PAINTER'S CHOICE**

One person Unit comes in kit form. This kit allows the user to complete an already existing compressed air filter system to take clean spray air and filter and monitor for Grade "D" Breathable Air. This kit comes complete with filters, monitor, air sampling fittings installation instructions and a 35' single line hose assembly.



**MONITORS**

are available for specific applications. We offer a complete line of broad range and electro chemical cell monitors. All monitors come complete with both audible and visual alarms. These monitors can be used to provide the required monitoring for supplied air breathing systems. Air sample kits to connect the monitors to the filtered air supply are available. Monitors are available to operate with either 110 V AC or 12 V DC power supply.



**FILTER SYSTEMS**

for pre filtration and breathing air filtration are available in 50 SCFM, 80 SCFM, and 150 SCFM sizes. As a part of the Your System...Your Way products, we call offer custom filters to fill specific needs. Standard filters are designed to work with the needs of air



**YOUR SYSTEM... YOUR WAY!!**

The Your System... Your Way products allow the end user to design a custom system to fit a specific need or situation. These products can be selected as needed to put together a complete system, or start with components and then add to them as time and money permit. Also, these products can be used to complete a system that does not currently meet the required OSHA standards. Products are available in 50 SCFM, 80 SCFM, and 150 SCFM sizes. Total flexibility with these products will make it possible to provide the right equipment for almost every situation.



### EDP-10 AMBIENT AIR PUMP

EDP-10 pump transfers ambient air from a clean air location to workers wearing C or CE type continuous flow supplied-air respirator hoods or tight-fitting half or full face masks, to ensure breathable air at all times.

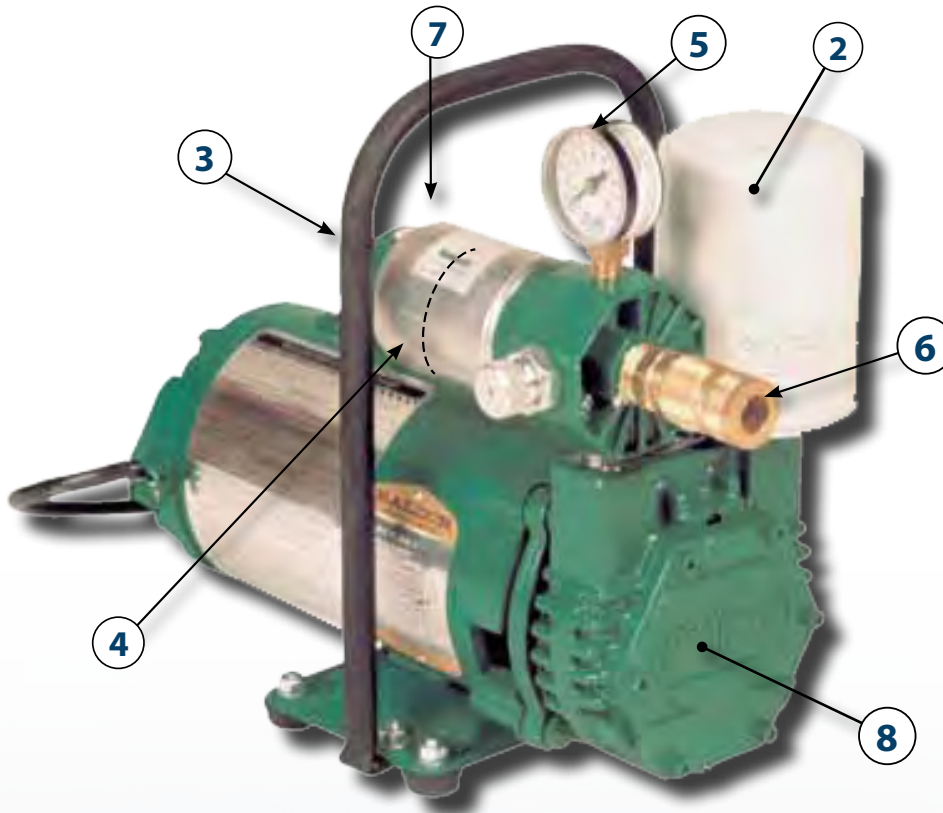

1	603101	COMPLETE EDP-10 PUMP
2	603152	INLET FILTER
3	603150	OUTLET FILTER
4	613284	"O" RING (NOT ILLUSTRATED)
5	603156	GAUGE
6	603153	QUICK CONNECT COUPLER
7	613281	FILTER BOWL
8	603175	SERVICE KIT (NOT ILLUSTRATED)



## INFORMATION / TECHNICAL ASSISTANCE

ISTblast is a registered trademark of:

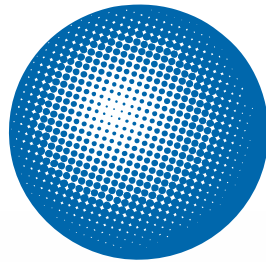

**International  
Surface  
Technologies**  

---

[istsurface.com](http://istsurface.com)

FOR MORE INFORMATION, PRICING OR TECHNICAL SUPPORT,  
CONTACT YOUR LOCAL IST DISTRIBUTOR OR CALL / FAX TO OUR

**TEL.: 1 877 629-8202 & 450 963-4400 FAX : 450 963-5122**

OR VISIT US AT:  
**[istsurface.com](http://istsurface.com)**



**OUR MAP LOCATION**

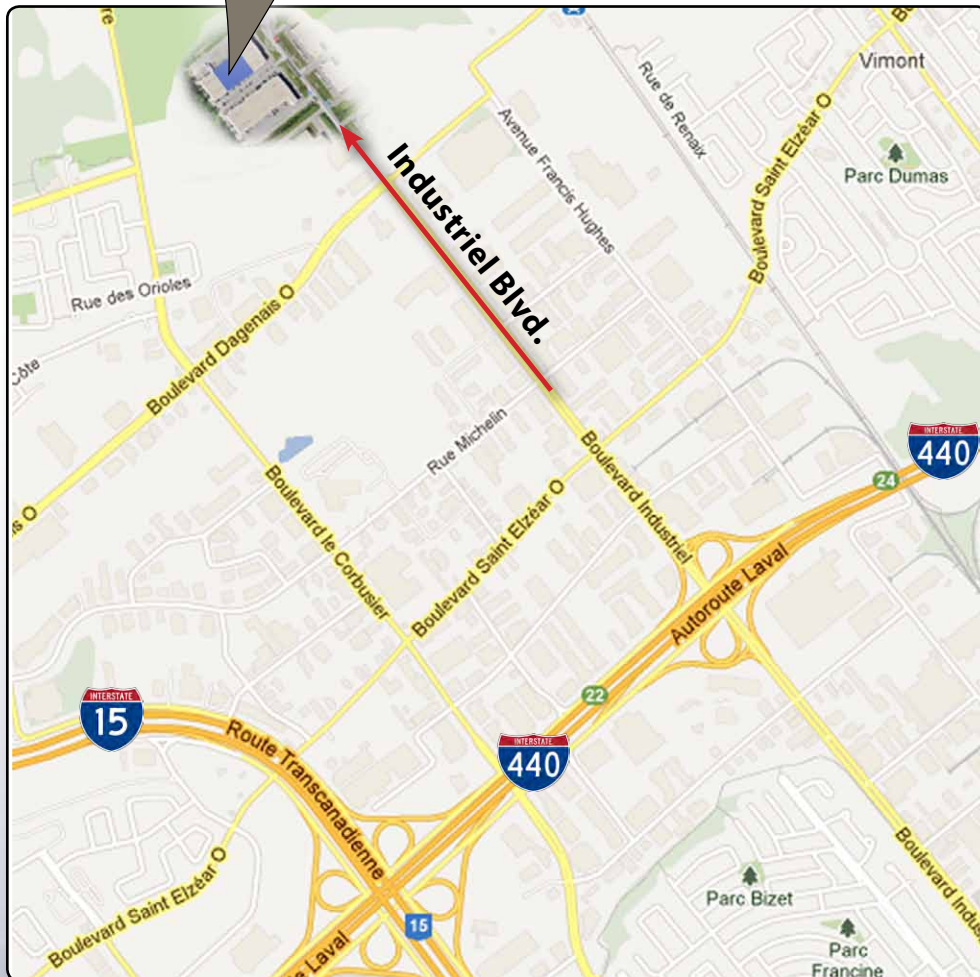



## ABOUT THE COMPANY

### WHO WE ARE

IST is a leading industrial manufacturer of standard and custom engineered equipment for the surface treatment industry and the solvent recycling industry.

### MISSION

IST is dedicated to being an innovative and trusted supplier in the conception, fabrication and distribution of surface treatment equipment and recycling equipment.

**The products, technologies and industry expertise of IST are used in a wide range of manufacturing and industrial applications, including but not limited to :**

- General Manufacturing
- Industrial Equipment
- Metal forming
- Aerospace and Aviation
- Rail and Transit
- Marine
- Automotive
- Petroleum
- Flexography (labelling) & Lithography
- Wood finishing
- Power & Energy
- Pharmaceutical

