

GWM 300



Ergonomic
cleaning height

ISTpure's spray gun cleaner **GWM 300** is an ergonomic and robust cleaner that is suitable for medium-to-heavy users. Its large manual cleaning station allows to clean efficiently the exterior and the interior of paint spray gun as well as PPS and other disposable cup adapters.

The **GWM 300** is a **hybrid cleaner** designed to clean either solvent-based or waterborne paint equipment in one simple to use system.

Increase the life span of your paint equipment of up to 75% and get ready for the next paint job in no time!

MARKETS SERVED

- Aerospace & Aviation
- Automotive
- Body Shop & Car Dealers
- General Manufacturing
- Marine
- Wood Finishing

KEY FEATURES

- ✓ **Single manual cleaning station** equipped with large basin, flow-through cleaning brush, manual rinse with clean fluid, air rinse / drying, and air blow gun
- ✓ **High power cleaning** up to 5 gal (20 liters) per minute
- ✓ **Cost-effective solution** for reducing solvent or waterborne fluid consumption and wastes, and for increasing painter's productivity
- ✓ **Automatic fume extraction built-in** vent when using solvent-based fluid
- ✓ **Solvent pail is kept inside** the cleaner housing
- ✓ **Low air consumption** of less than 2 cfm, thanks to Graco's high efficiency air-operated double diaphragm pump
- ✓ **Long-term warranty** : parts 2 years / pump 5 years
- ✓ **Environmental-friendly solution** : Reduces solvent or waterborne fluid consumption, hazardous waste, and VOC emissions

ACCESSORIES INCLUDED / OPTIONAL

- ✓ Air blow gun
- ✓ Adapter tubes and fitters
- ✓ Exhaust for solvent fume extraction
- ✓ Blue Filter kit (optional)
- ✓ Instruction Manual

IST surface manufactures standard and custom spray gun cleaners and cleaning equipment to be used with solvents or waterborne fluids. In addition to offering a wide selection of cleaning equipment, IST surface specializes in innovative engineering, integrated systems for compact to large parts. IST surface designs solutions for challenging parts washers, solvent recycling and surface treatment applications.

INSIDE VIEWS

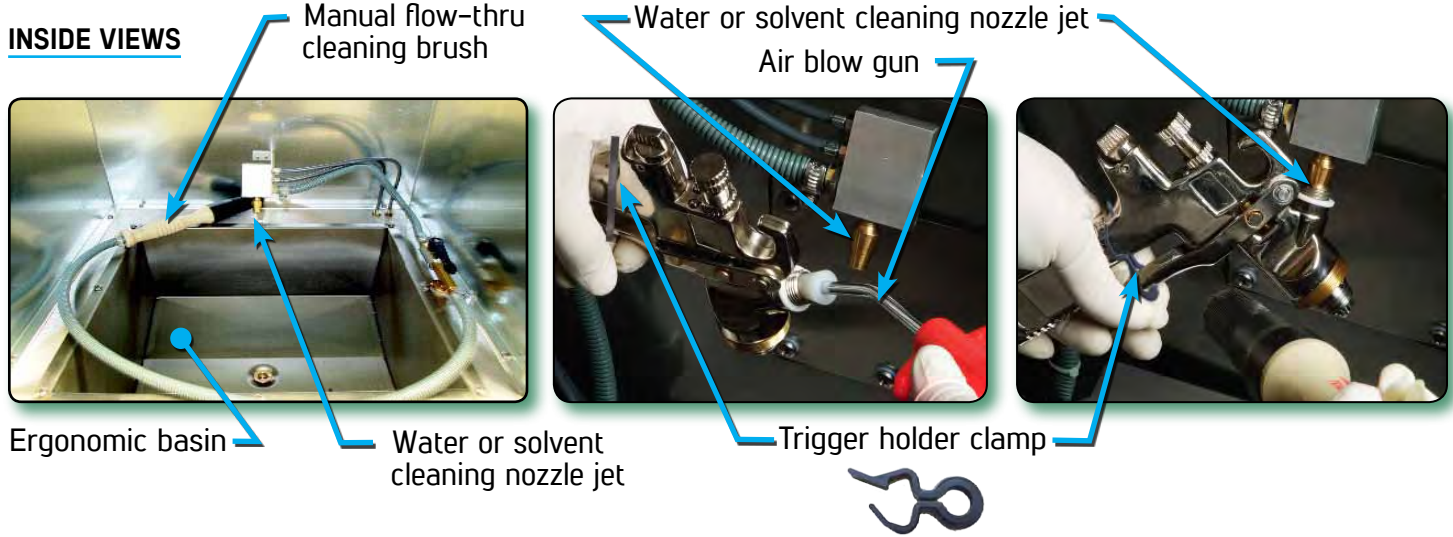

WE ALSO RECOMMEND



The optional inline filtration system "Blue Filter" enhances the cleaning performance of the cleaner, increases its life span, lower its maintenance, and reduces wastes by filtering out the particules from cleaning fluid.

POWERED BY A GRACO AIR OPERATED DOUBLE DIAPHRAGM PUMP



All our cleaners are powered by Graco's high efficiency air-operated double diaphragm pump providing a high performance fluid delivery with very low air consumption.

- Long-term 5 year warranty
- Air consumption: < 2 cfm
- Air input: 40-90 psi
- Output : 5 US gal per minute at 90 psi
- Air input connection: 1/4 NPT

CHARACTERISTICS

Cleaning Station(s)	1 Manual
Cleaning Station Capacity	1 Paint Gun / 1 Cup
Dimensions (H x W x D)	60" X 21" X 15 3/4"
Weight	104 lb
Air input	40/90 psi
Air input connection	1/4" NPT
Warranty Parts / Pump	2 years / 5 years
Product No.	350300

ISTpure SOLVENT RECYCLER



Combine your cleaner with ISTpure's Solvent Recycler to increase your return on investment (ROI) by reducing used solvent wastes and pure solvent purchases.

Visit www.istpure.com for more details.